

ecobay

User Manual

SEA889-WIFI(TY)

ecobay

Thermostatic Radiator Valve

User Manual

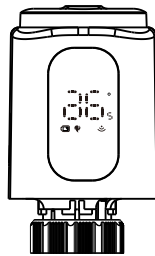

SEA889-WIFI(TY)

What is in the box?

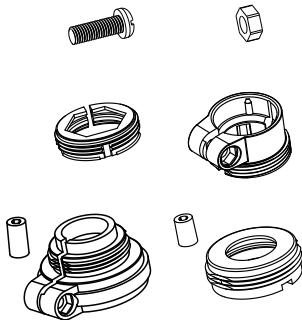
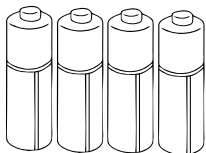
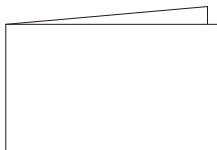
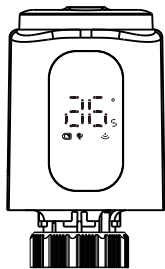

Content

Specifications	01
Controls and displays	02
Installation	03
Adaptor Introduction	05
Configuration	08
Link APP	11
Voice Control	19
Warning	21

Specifications

* **Power source:** 4x1.5V alkaline AA batteries (LR6)
(Don't use the rechargeable battery)

* **Temperature setting accuracy:** 0.5°C

* **Temperature display range:** 0°C~50°C

* **Setting temperature range:** 5°C~30°C

* **Shipping & storage temperature:** -10°C~60°C

* **Network frequency:** 2.4GHz WIFI

* **Display screen:** LED

* **IP class:** IP21

* **Connection:** M30x1.5mm

Low power consumption recommendations:

We suggest turning on Energy-saving mode to extend battery life.

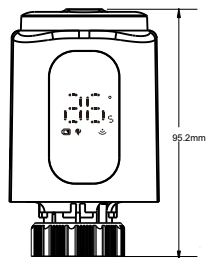
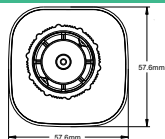

Controls and Displays

Control Dial:
Rotate to change temperature

Key lock / code match /
Button to change mode
(Programmable, Non-programmable)

LED display
Low battery indicator
Heat output

Wifi Connection
Programmable mode

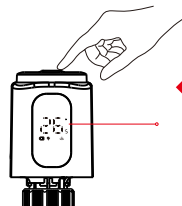
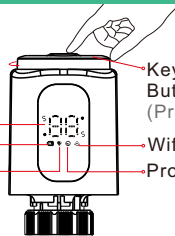

◆ **IMPORTANT:**

In "OF" state, press the control dial 5 times continuously, the value display will be reversed.

Installing battery steps



Warning

Do not unplug this control dial while installing the battery.

Press buckle to take off cover

Thumbs lightly press here

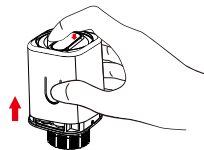
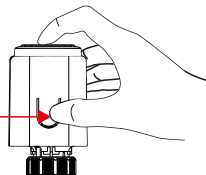

Gently pull up the housing cover while pressing down on the rotary plate with the index finger.



2

4*1.5V alkaline AA batteries

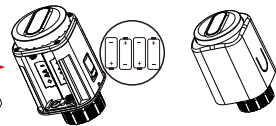

* Insert the batteries checking the polarities (+ / -) are correctly aligned.

3

Fitting on the radiator valve

1 Display show "LR" flashing.



2 Once valve needle is flush with the base.

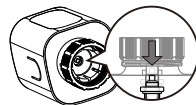

3 Install thermostat with M30*1.5 screw thread interface of valve. Tighten the plastic ring.

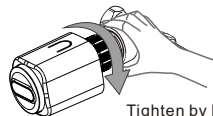

Tighten by hand

4 Press the control dial lightly. The "LR" display starts to flash. The radiator thermostat now carries out an adaptation run.

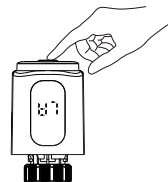



* Tips:

After tightening by hand, do not use a wrench to twist it twice, in case too much force and damage the ring.

Adapter selection

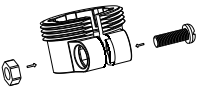
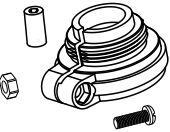
Please confirm valve diameter

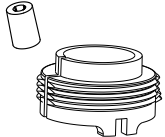
Danfoss		Caleffi	Giacomini
1/2 valve (RA)	3/4 valve + long plunger	1/2 valve	1/2 valve + short plunger
			

Fitting the adapter

Danfoss

1/2 valve (RA)

Please tighten the screws after fixing the valve connector.

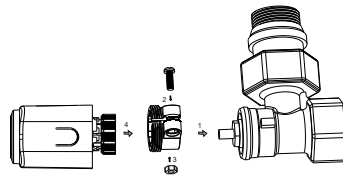

Danfoss

3/4 valve

Put the adapter directly on the valve. Tighten the screws. Put a long plunger at bottom of the thermostat.

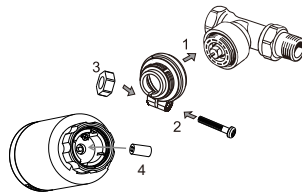

Caleffi

1/2 valve

Put adapter directly on the valve.

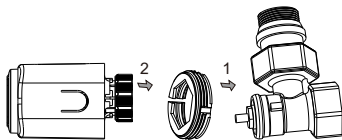

Giacomini

1/2 valve

Put adapter directly on the valve.
Put a short plunger at bottom of the thermostat.



Configuring the thermostat

ON / OFF

- If the temperature is set at $<5^{\circ}\text{C}$, "0F" appears in the display.
- If the temperature is set at $>30^{\circ}\text{C}$, "0N" appears in the display.

Window open detection

- If a window is opened while the heating is on, the radiator thermostat automatically will stop the heating process when the temperature falls rapidly. (Temperature drop 6°C within 4 min)
- "0P" appears in the display. As soon as the window is closed and the temperature has risen again by 3°C , the radiator thermostat automatically returns to normal operation.

Limescale protection

- If the radiator valve is not opened for two or more weeks, this can cause limescale to build up in the valve.
- To prevent this, the radiator thermostat opens the valve for 30 seconds every two weeks. The display shows "Ad" during this process.

Tips: The anti-scale function can be activated by pressing rotary plate 5 times continuously in "0N" state until the display shows "Ad". Pressing rotary plate 5 times continuously again until the display shows "Af" to turn off anti-scale function.

Energy-saving

After entering the energy-saving mode, the app cannot control the device within 00:00~06:00, but the device is working normally.

The energy-saving mode can be activated by long pressing the control dial over 5s in "00" state until the display shows "01". Long pressing the control dial 5s again until the display shows "00" to exit energy-saving mode.

Anti-freezing function

In the power-off state, when the screen displays "🔥", it means the antifreeze function is on.

- If the temperature falls below 5°C, the thermostat automatically activates the heating.
- Heating continues until the temperature reaches 8°C. The thermostat then switches back to Off mode.

Child lock function

To prevent children from setting thermostat, the child lock function can be activated by long pressing the control dial until the display shows "L". Long press the control dial over 10s to unlock.

Geofencing function

When it detects that no one is at home, the thermostat will turn off heating to save energy. Users can operate the settings through the APP.

Alarm

In the normal operation range:
NTC sensor damage, display: Er





Low power alarm

When the battery voltage is extremely low, the alarm symbol  will appear, which reminds that the user shall replace the batteries.

Temporarily override

Adjusting the temperature in the current interface is only valid within the current period of time, but the original programming will be restored in the next period of time.

Default programming (4 period programming)

							
Wake up		Out door		Back home		Sleep	
6:00	20°C	8:00	16°C	18:00	20°C	22:00	16°C

Link APP (Login)

Download:

Click App store or Android application market to download "Tuya Smart" app.



Registration and Login:

Click the "Register" to create account. Enter your account password to log in

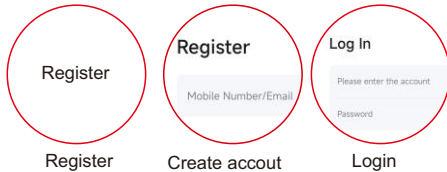

Link APP

Tips: Turn on Bluetooth and wifi on your mobile phone.

- 1 For thermostatic radiator valve: In "OF" state, long press the control dial until the screen show "--".

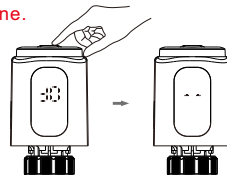

- 2 Click "Add Device" to enter the device list.



- 3 Click the device which you want to add.



- 4 Enter wifi account & password, then click "Next".



- 5 Search device
Wait a few seconds until the thermostatic radiator valve appears "FF"



- 6 Click "Done", it means the device added successfully.



Temperature setting

After the thermostat is added successfully, we can control the device through the APP. Press \wedge or \vee to increase or decrease of the temperature.



* Tips

When thermostat is in programming function:

Adjusting the temperature on the current interface will only be effective in the current period of time but recovers the original programming in the next period of time.

Power On/Off Setting

Click ">> Switch off" and drag to right to turn the power off.
Click "<< Switch on" and drag to left to turn the power on.

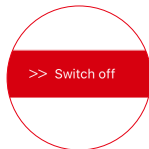

* Tips

If you will be away for a long time, and no heating equipment is required at home, you can directly switch it off. The thermostat will automatically enter the "anti-freezing mode", which is started at the room temperature less than 5°C and closed at the room temperature over 8°C, so as to prevent the radiator from heating failure because of being frozen.

Temporary leaving setting

- 1 If you need to stay out temporarily, please click "Away" key.

The temperature will remain at 16°C, the energy-saving icon "Ⓢ" turns green.



- 2 After you arrive home, click "Home" key to recover the previous temperature setting.



Thermostat displays "16"

Programming setting

- 1 Click "program" to enter the programming interface.
- 2 Select the period of time of 7-day programming, press "∧" or "∨" to set temperatures in the different periods of time.

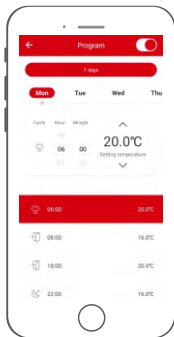

- 3 Enter the programming interface and then click the "7 day" key.
- 4 Click the day to be edited and confirm it.

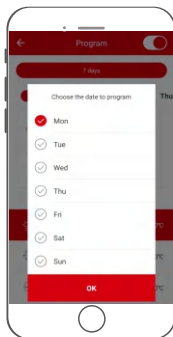

Implicit parameter setting

Click "Setting" to enter the Implicit parameter setting interface.

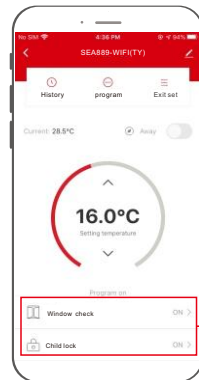

Slide to set more parameter

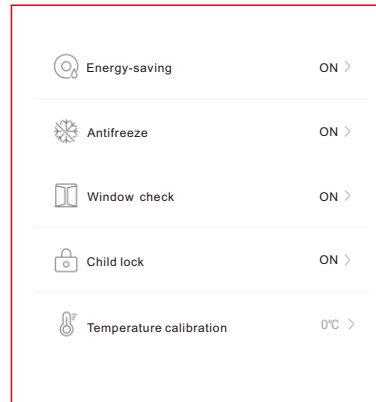

Exit network / Remove devices

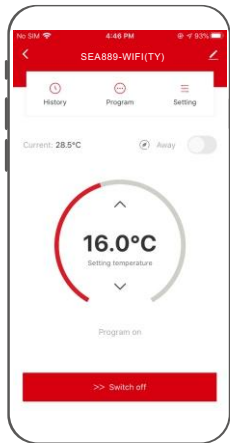

- 1 Click the button “”
In the upper right corner of the interface
- 2 Click “Remove device”.

Click “remove device”
to select Disconnect /
Disconnect and wipe
data / Cancel

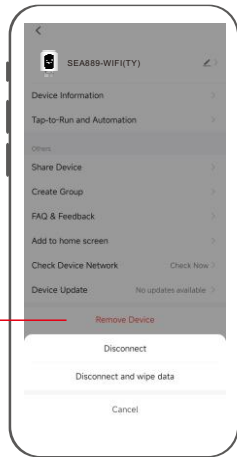

Voice command :

After waking up the speaker, you can say:

Amazon Alexa

- * Turn on bedroom.
- * Turn off bedroom.
- * Raise the bedroom by 1 degree.
- * Drop the bedroom by 1 degree.
- * Set the bedroom to 16 degrees.
- * What is the temperature of bedroom?

Google Assistant

Tips:you need connect to the Google speaker

- * Turn on bedroom.
- * Turn off bedroom.
- * Raise the bedroom by 1 degree.
- * Drop the bedroom by 1 degree.
- * Set the bedroom to 16 degrees.
- * What is the temperature of bedroom?

* Tips: bedroom is the device name. You can name it by yourself.

* The temperature unit of thermostat and speaker must be the same.

WARNING

Care and Maintenance

Disconnect the device from the mains before cleaning and during prolonged periods of non-use. Only clean this product with a slightly damp, lint-free cloth and do not use aggressive cleaning agents.

Warranty Disclaimer

ECOBAY assumes no liability and provides no warranty for damage resulting from improper installation/mounting, improper use of the product or from failure to observe the operating instructions and/or safety notes.

Service and Support

Please contact ECOBAY Consulting if you have any questions about this product.

Note on environmental protection:



After the implementation of the European Directives 2012/19/EU and 2006/66/EU in the national legal system, the following applies:

electrical and electronic devices as well as batteries must not be disposed of with household waste. Consumers are obliged by law to return electrical and electronic devices as well as batteries to the designated public collection points or to the point of sale at the end of their service lives. Detailed information on this topic is defined in the national laws of the respective country. This presence of the above symbol on the product, operating instructions or package indicates that the product is subject to these regulations. By recycling, reusing the materials or other forms of utilising old devices/batteries, you are making an important contribution to protecting our environment.

Declaration of Conformity

ECOBAY hereby declares that the radio equipment type of SEA889-WIFI(TY) is in compliance with Directive 2014/53/EU.

Frequency band(s) 2.4 GHz

Maximum radio-frequency power transmitted < 100mW



SEA889-WIFI(TY)

Manufacturer Name: SHENZHEN SASWELL TECHNOLOGY INC.

Address: Room 1601-1602, Building4, Tianan Cloud Park, Bantian Street, Longgang District, Shenzhen, 518129, China

E-mail: amazon@saswell.com

Battery Safety Warning: Use only specified batteries.

Batteriesicherheitswarnung: Verwenden Sie nur die angegebenen Batterien.

Installation Warning: Ensure batteries are inserted correctly.

Installationswarnung: Stellen Sie sicher, dass die Batterien korrekt eingelegt sind.



EVATOST CONSULTING LTD

Office 101 32 Threadneedle Street, London,
United Kingdom, EC2R 8AY
contact@evatost.com

UK001723714619462iiZq